

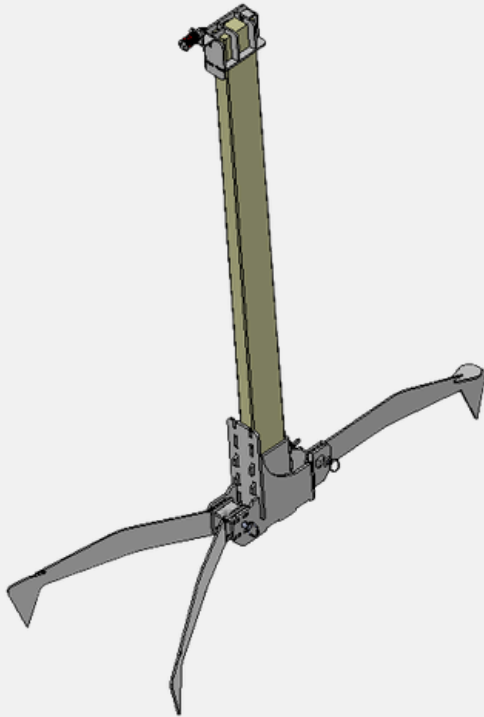

SPIKED 2x4 BASE & HANGER



Part Number

TS-SC-QS-001

TS-SC-QS

Tools Required

- **3/4" Wrench**
- **3/4" Socket & Ratchet**

Hardware Included W/ Base

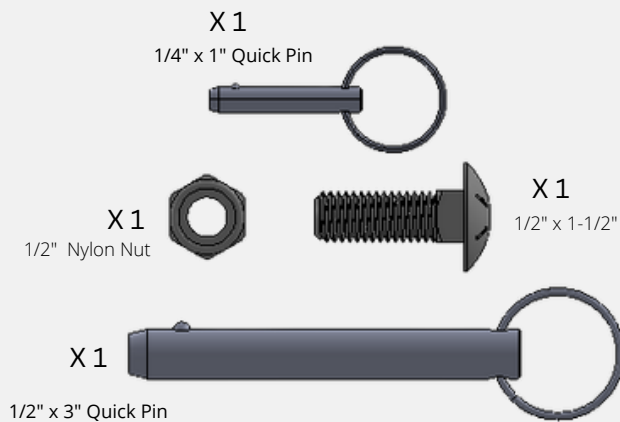

Only Included if you purchased
Stand and Hanger Kit

Hardware Included W/ Hanger

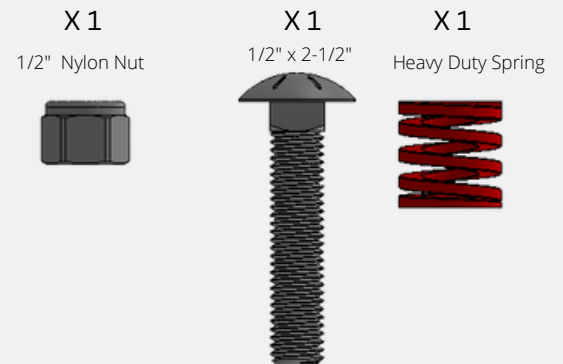



Assembly Steps:

1. Layout all items onto work bench
2. Insert the 3 Legs into the Base, then insert 1/2" x 3" quick pin into the hole on mounting base to secure the back two feet, as Shown in Fig. 1
3. Insert 1/2" x 1-1/2" Carriage Bolt through the Base and Leg, tighten to secure the Leg, but do not overtighten as the Leg should rotate freely, as Shown in Fig. 2
4. Insert 1/4" x 1" quick pin to secure leg from rotating, as Shown in Fig. 1

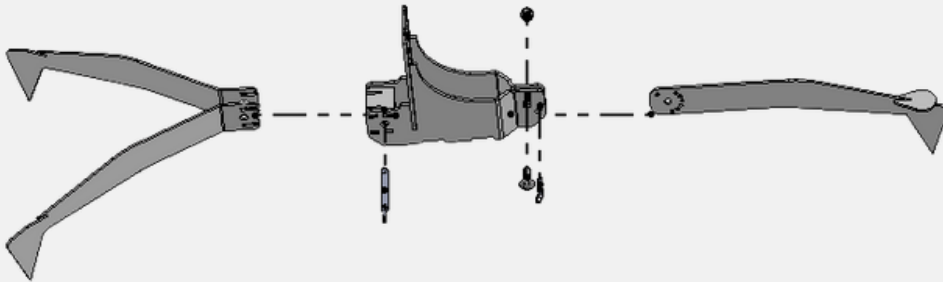

FIG 1.

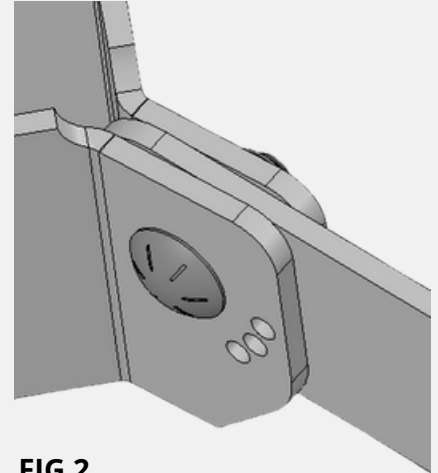

FIG 2.

Assembly Steps Continued:

5. Install 2x4 Base Mount into The Base with feet. Fig. 3
Note: 2x4 Base Mount can be installed at multiple Heights See last page of instructions
6. Cut 2x4 to length depending on desired height and insert into Base Mount, tighten wing nut into 2x4.

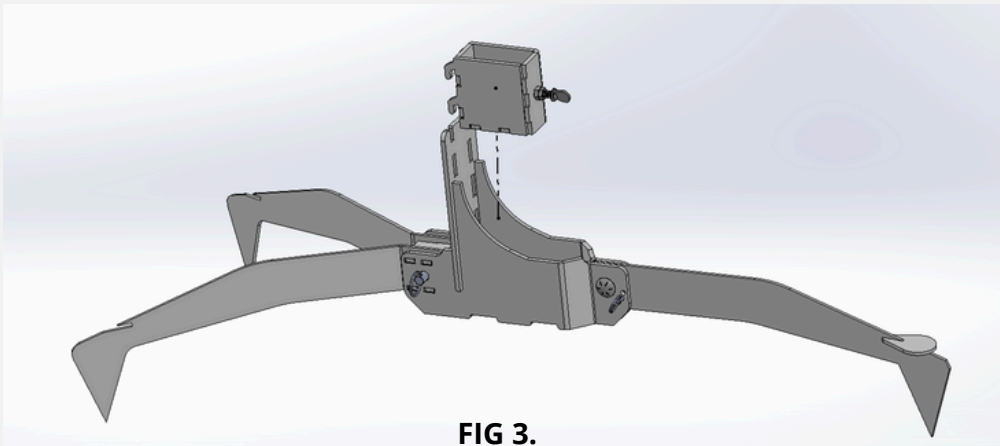

FIG 3.





Assembly Steps Continued:

7. Install 2x4 Hanger Mount onto the 2x4
8. Tighten Wing Nut into 2x4 to hold it into place
9. Install silhouette by using the 1/2"- 2 1/2" carriage bolt, 1/2" Nylon Nut, and the Heavy Duty Spring as shown below in Fig. 4 & Fig.5

FIG 4.

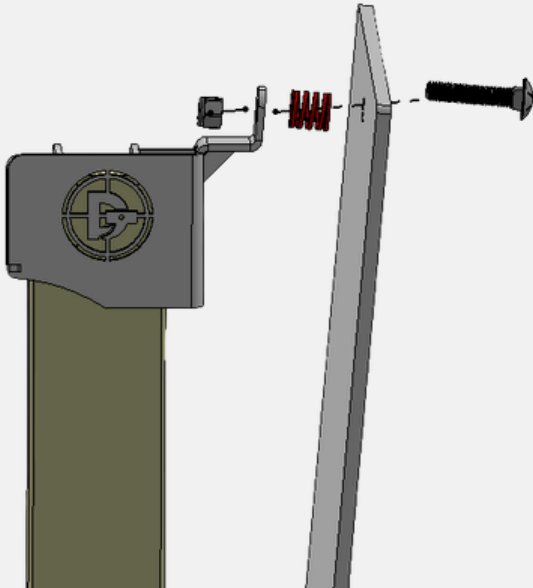
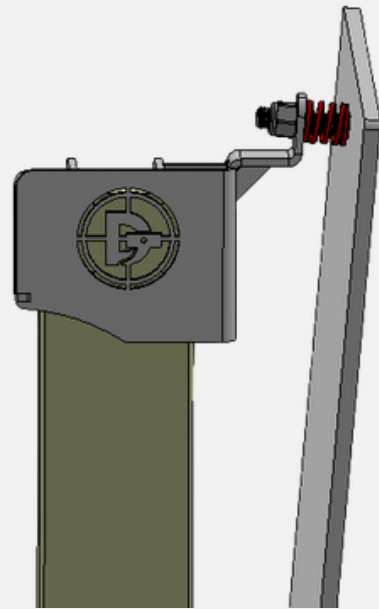

FIG 5.



Tips for Adjusting the Base

- To adjust the base, you have two options:

- Option 1:

- Adjust the Height by using the adjustment provided in the base stand, as shown in Fig. 6 & 7.
- It is easier to adjust the height by removing the 2x4 and steel target or having someone help, as the targets can be heavy.

To Adjust, just remove from the slots and slide into a different row

FIG. 6

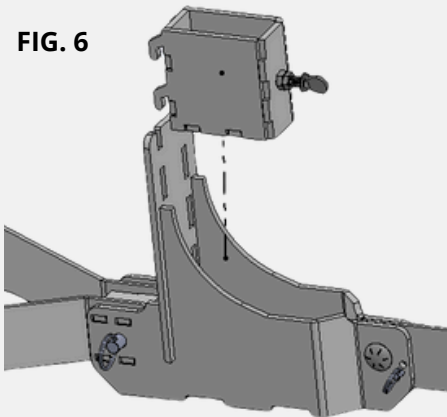

Notice the Additional slots for the hanger to clip into place

FIG. 7

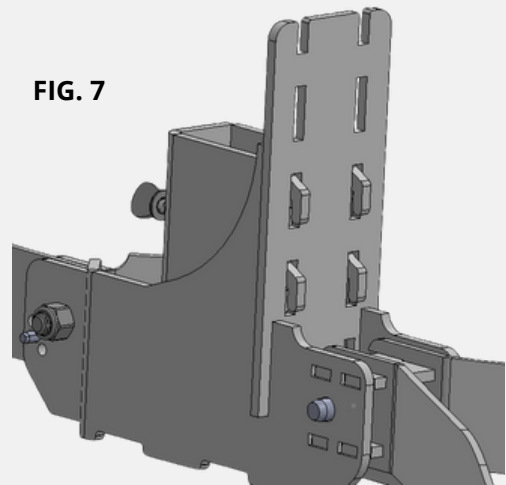

- Option 2:

- Adjust using the Front Leg Quick Pin Adjustment. Before doing this, you should remove the 2x4 holding the target as it is too heavy to adjust with the steel installed. Remove the 1" Quick Pin, adjust the angle, and re-install the Quick Pin. There are 3 locating holes in the front base and 6 holes in the front foot; this gives you adjustment in intervals of 5 degrees each. Use the front foot and the adjustment holes to adjust the stand angle, as shown in FIG. 8

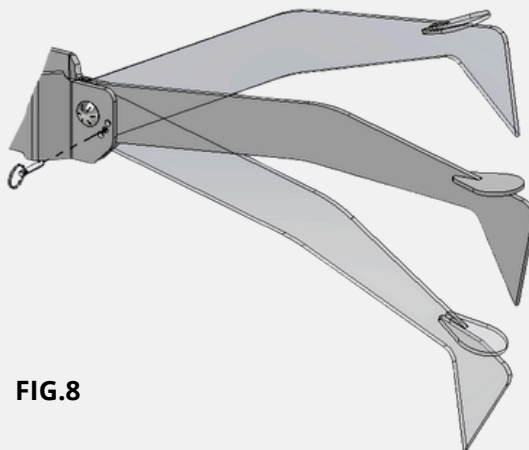

FIG.8



H-Base- Stand Base

Part Number

TS-HB-2X4

Tools Required

- 13mm Wrench

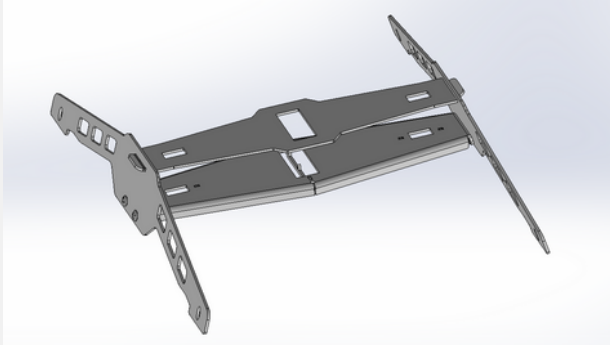

Assembly Steps: (Part will be assembled upside down)

1. Layout all items onto work bench
2. Slide the Top Cross Support into the feet, as Shown in Fig. 1
* *Note. Bends go toward work bench/facing top of stand**
3. Slide Bottom Cross Support in between feet, as shown in Fig. 2
4. Insert Carriage bolts & finger tighten Nuts onto bolt as you install all 4 pieces, as shown in Fig. 3
5. Tighten All Hardware

FIG 1.

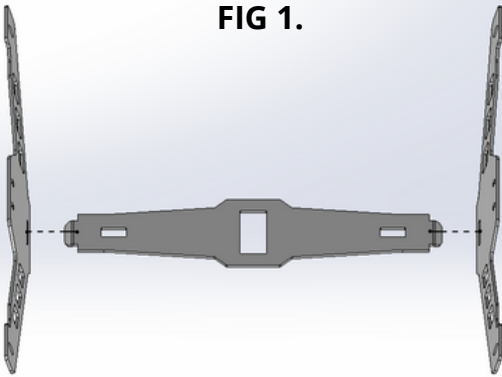

FIG 2.

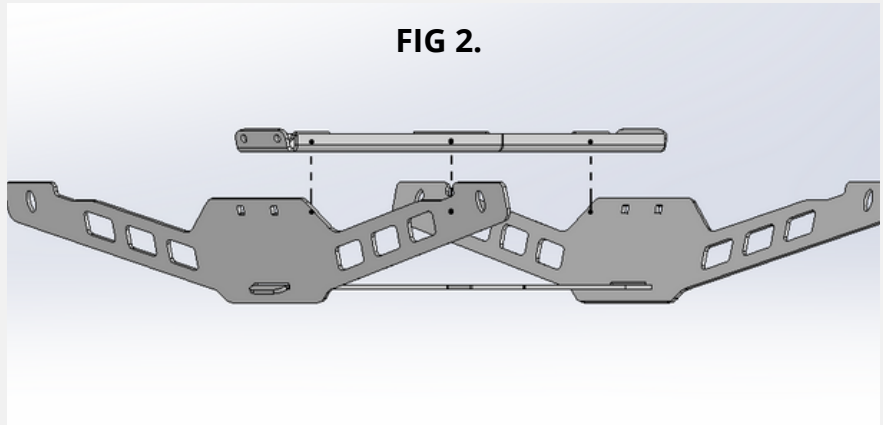

FIG 3.

